

ARM Product Pulse

Your source for the latest ARM updates and best practices

Issue #12

ARM 2021.1 Features and Enhancements

Run "Check for Updates" to take advantage of latest developments.

Highlights include:

Easily Spot New Features With Temporary Highlighting

How long will the highlighting last?

- New entry fields (a) = 30 days
- New features (b) = first 10 times displayed on-screen

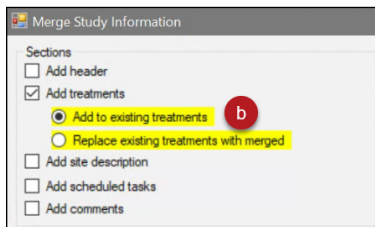

Turn off highlighting at any time

- Tools> Options > Display Tab

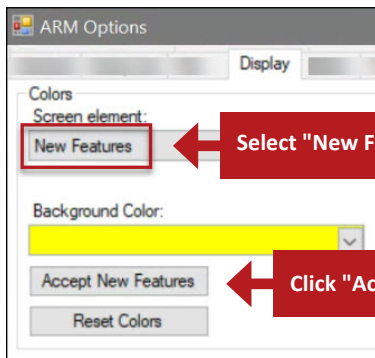

Select "New Features"

Click "Accept New Features"

Operation Pressure			
Nozzle Model			
Nozzle Type			
Nozzle TradeName			
Nozzle Tip Size, Color			
Nozzle Spacing			
Nozzles/Row			

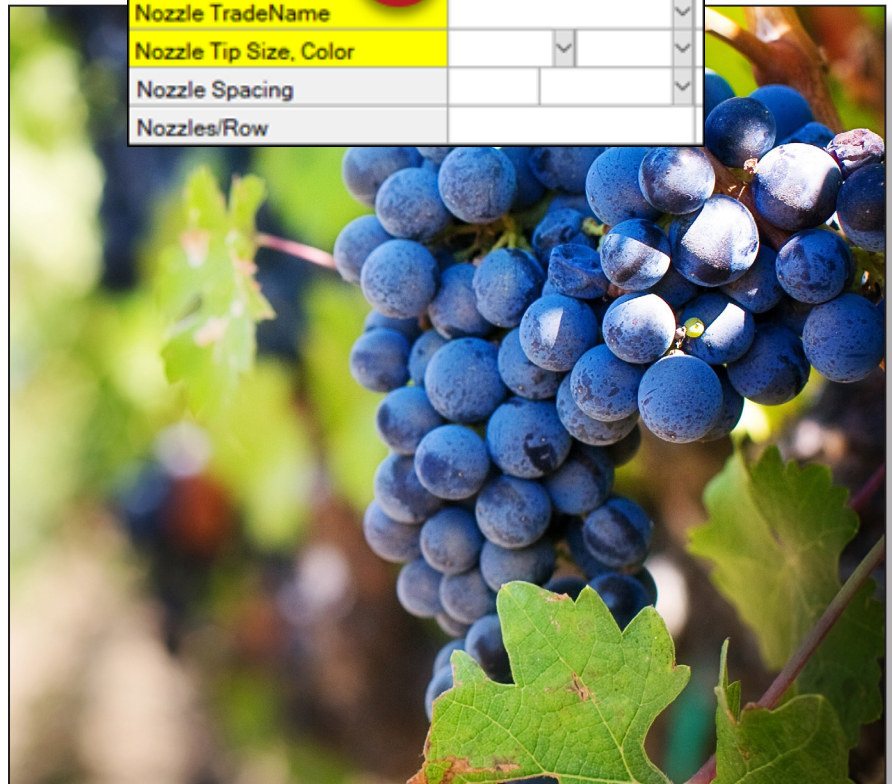

Speed Up Data Entry: New Drop Down Lists

Limited/short validation lists replaced with simple drop-down selection.

Find these time-savers in both Protocol and Site Description.

See it in action [HERE](#)

		A
Application Date	Apr-15-2021	
Crop 1 Code, BBCH Scale	TRZAW	BCER
Stage Scale Used	BBCH	
Stage Majority, Percent	32	100
Diameter Average		
Diameter Minimum, Maximum		
Height Average		
Height Minimum, Maximum		



ARM Product Pulse

Your source for the latest ARM updates and best practices

NEW Save Time with Merge Feature: Replace

Previously, the *Merge* tool only added information to the current study. The new *Replace* feature deletes old/incorrect information and replaces with selected components. Update the trial map randomization at the same time!

View the short video [HERE](#)

Steps to Replace Crop and/or Pest Description

1. Tools > Merge > from ARM Study ...
2. Select the **Protocol/Trial** to copy the new information from and click **OK**
3. Select "**Add protocol description**" or select "**Add site description**" (when working in a trial) and click **OK**
4. Check **Crop and/or Pest Description**
5. Select **Replace** for merging method and click **OK**

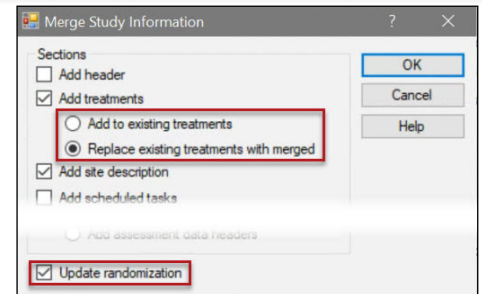

NEW Increase Assessment Data Accuracy with Rating Unit Min/Max Fields

Enter custom range for smallest and largest number valid for the assessment. Units with defined data limits (e.g. percent, pH, etc) are auto-filled. Entering data out of range triggers an alert.

Part Rated	PLANT	C
Rating Type	VIGOR	
Rating Unit/Min/Max	%	0 100

Note: ARM Action codes defining data limits no longer exist. Data limits are now set in only one place (previously set in Action Code, Rating Type, and/or Unit).



ARM Webinars Archived for You

If you missed our April 2021 webinars, you can view them at any time on our website. The topics covered provide useful tips and tricks for this season's research! Check them out [HERE](#)

- Collect Data with TDCx (Tablet Data Collector)
- Labels and Barcodes in ARM
- Trial Map Randomization
- Summary Across Trials: The Basics

